



**FLAMEBLOCK<sup>®</sup>**  
FIRE-RATED OSB SHEATHING



ASSEMBLIES AND APPLICATIONS  
FOR BUILDERS



CODE COMPLIANCE,  
STRENGTH AND SAVINGS  
IN ONE PANEL

[LPCorp.com/FlameBlock](http://LPCorp.com/FlameBlock)

**BUILD WITH US<sup>®</sup>**

**STRUCTURAL STRENGTH  
AND CODE COMPLIANCE  
IN A SINGLE PANEL**



LOOK BENEATH THE IGNITION-  
RESISTANT PYROTITE COATING AND  
YOU'LL FIND THE STRENGTH  
OF LP® OSB.

LP® FLAMEBLOCK® FIRE-RATED OSB  
SHEATHING FEATURES A PROPRIETARY  
NON-COMBUSTIBLE,  
FIBERGLASS-REINFORCED  
PYROTITE™ TREATMENT.

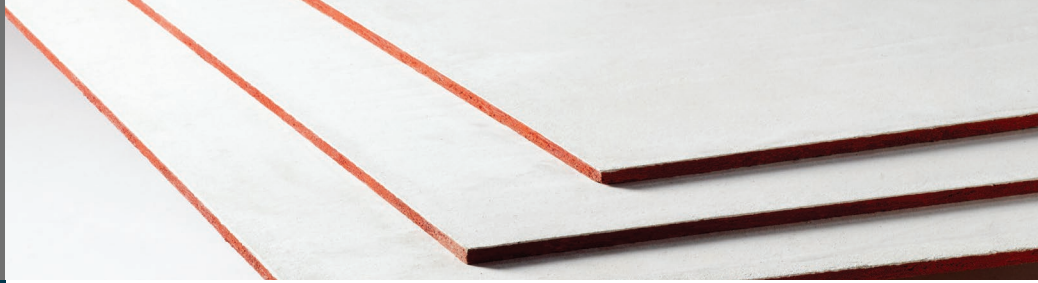

Now there's a way to meet single-family fire code and get greater savings: LP® FlameBlock® Fire-Rated OSB Sheathing. It's an ICC-certified component of 1-hour and 2-hour fire-rated wall assemblies and roof deck applications, and it offers many advantages over gypsum and FRT plywood.

**CODE-APPROVED FIRE-RATED STRUCTURAL SHEATHING**

- ICC-certified (ESR-1365)
- 15-minute thermal barrier protection (UBC 26-2)
- 30-minute Class A Flame Spread Rating (ASTM E84, UL723)
- Combination of flame-spread resistance and burn-through resistance

**STRENGTH**

Carries design values for load/span and shear that are superior to fire-retardant treated wood structural panels of the same thickness.

**WEATHER RESISTANCE**

Exposure 1 classification certifies that LP FlameBlock sheathing is able to withstand exposure to moisture during normal construction delays. FRT plywood does not carry Exposure 1 certification.



# INTERIOR ASSEMBLIES SIMPLIFY INSTALLATION AND INCREASE STRUCTURAL RATINGS

LP FlameBlock interior wall assemblies can streamline installation and lower material/labor costs by reducing the need for additional construction materials.

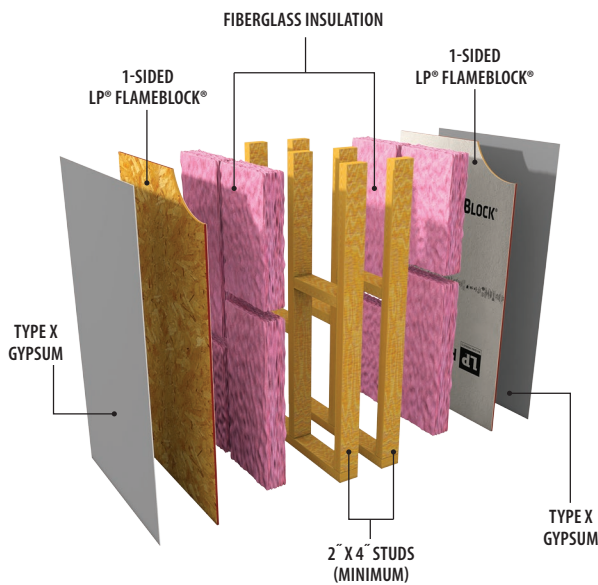

## INTERIOR LOAD-BEARING WALL – UL DESIGN NO. U350 (TYPE A)

(2-HOUR PARTITION WALL; FIRE-RATED ON BOTH SIDES)

- Commonly used in Type V 2-hour partition walls
- Reduces material/labor costs and dead load by eliminating two layers of gypsum
- Eliminates need for additional materials (C channels, H studs, breakaway clips)
- Allows for standard OSB design values, while FRT plywood must take deductions
- Sound Transmission Class (STC) rating of 62

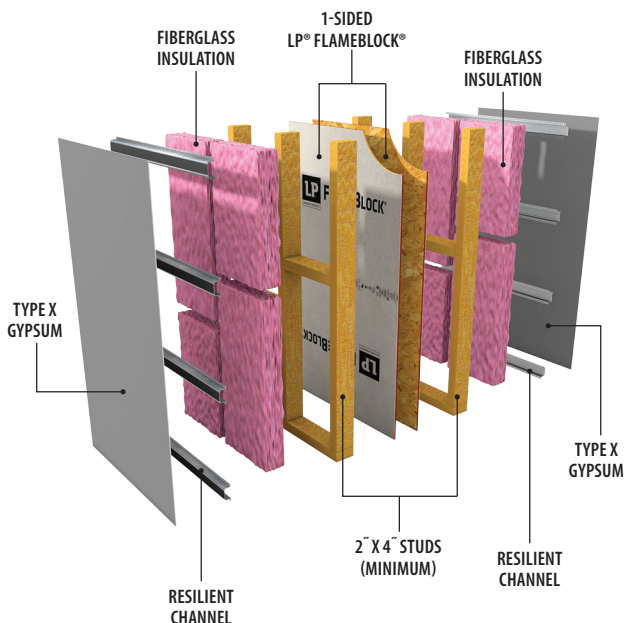

## INTERIOR LOAD-BEARING WALL – UL DESIGN NO. U350 (TYPE B)

(2-HOUR PARTITION WALL; FIRE-RATED ON BOTH SIDES)

- Commonly used in Type V 2-hour partition walls
- Reduces material/labor costs and dead load by eliminating two layers of gypsum
- Eliminates need for additional materials (C channels, H studs, breakaway clips)
- Allows for standard OSB design values, while FRT plywood must take deductions
- Sound Transmission Class (STC) rating of 62

# ROOF DECK APPLICATION DELIVERS EXPOSURE 1 WEATHER RESISTANCE

LP FlameBlock sheathing in roof deck applications outperforms FRT plywood in structural design rating at the same panel thickness. With its Exposure 1 classification, LP FlameBlock sheathing is able to withstand exposure to moisture during normal construction delays. (FRT plywood does not carry Exposure 1 certification.)

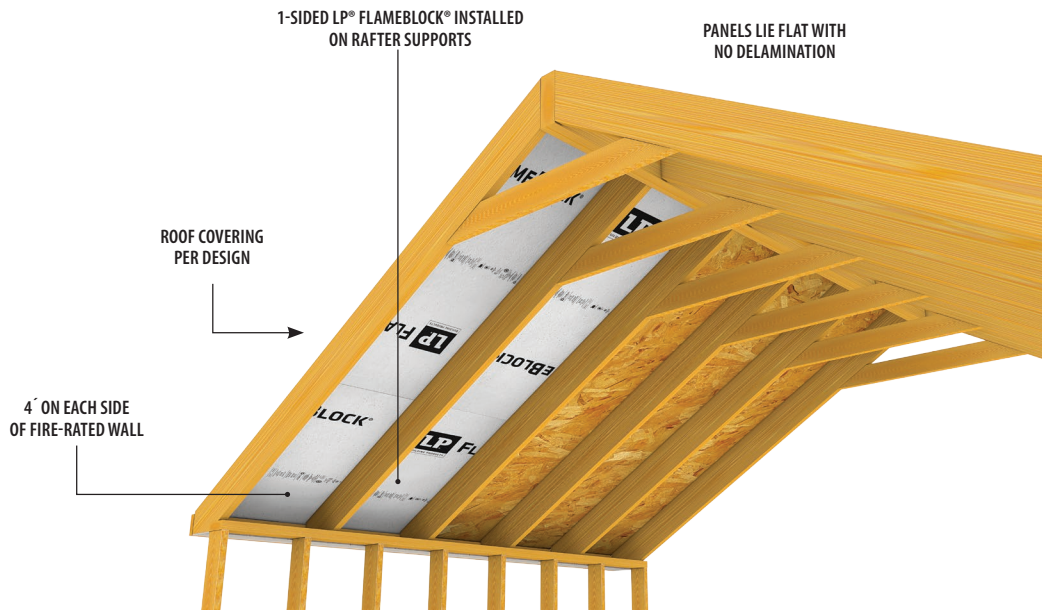

## ROOF DECK – TYPE III & V CONSTRUCTION

- Higher load/span ratings than FRT plywood at same thickness
- Available in a range of thickness categories, including 7/16" to provide consistency with 7/16" standard OSB where applicable
- Certified Exposure 1 weather resistance
- Reduces labor costs and construction time compared to gypsum-over-wood structural panel option

# EXTERIOR ASSEMBLIES REDUCE MATERIAL AND LABOR COSTS

Exterior wall assemblies using LP FlameBlock sheathing can reduce construction time and labor costs by eliminating the time required to install a layer of external gypsum. In addition, these assemblies can reduce dead load and wall thickness versus common alternatives and provide a better substrate for securely fastening exterior cladding.

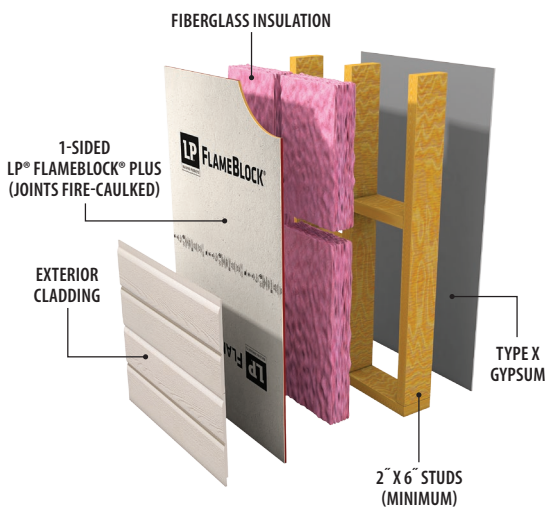

## EXTERIOR LOAD-BEARING WALL – UL DESIGN NO. V311

(FLAMEBLOCK PLUS 1-HOUR WALL; FIRE-RATED FROM BOTH SIDES)

- Commonly used in Type V load-bearing exterior walls along property line, including single-family construction
- Reduces dead load and wall thickness versus common alternatives
- Reduces labor costs and construction time\*
- Provides better substrate for securely fastening exterior facing
- Allows brick, stucco, steel and fiber cement exterior facings
- Exposure 1 classification; withstands normal exposure to moisture during construction

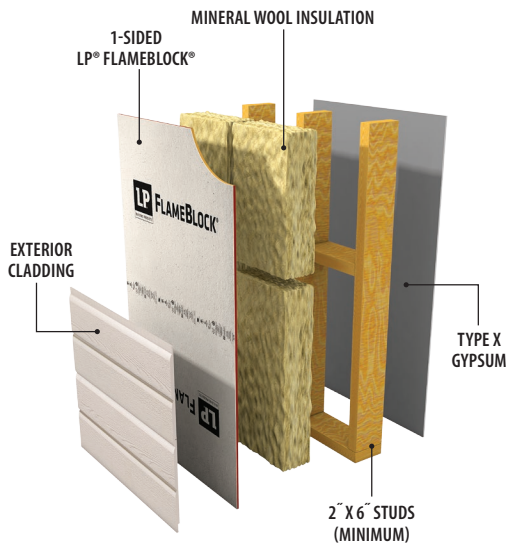

## EXTERIOR LOAD-BEARING WALL – INTERTEK LISTING LPB/WPPS-60-01

(1-HOUR WALL; FIRE-RATED FROM BOTH SIDES)

- Commonly used in Type V 1-hour exterior walls along property line, including single-family construction
- Reduces dead load and wall thickness versus common alternatives
- Reduces labor costs and construction time\*
- Provides better substrate for securely fastening exterior facing
- Allows a range of code-compliant exterior facings
- Exposure 1 classification; withstands normal exposure to moisture during construction

\*Eliminates a layer of gypsum vs. UL301 and U308.

LP® FlameBlock® Fire-Rated OSB Sheathing helps you meet fire codes while reducing dead load and wall thickness versus common alternatives. It reduces labor time and costs compared to FRT plywood at the same thickness and provides a better substrate for securely fastening exterior facing.

Meeting fire codes just got easier. Choose LP FlameBlock sheathing for your next project.

## DRIVING FIRE-RESISTANT CONSTRUCTION IN WALLS AND ROOFS



For more information about LP FlameBlock Fire-Rated OSB Sheathing, including our Technical Guide, call 1-888-820-0325 or visit [LPCorp.com/FlameBlock](http://LPCorp.com/FlameBlock)

[LPCorp.com/FlameBlock](http://LPCorp.com/FlameBlock)  
Phone: 1-888-820-0325  
Fax: 1-877-523-7192  
Email: [Customer.Support@LPCorp.com](mailto:Customer.Support@LPCorp.com)

Cal. Prop 65 Warning: Use of this product may result in exposure to wood dust, known to the State of California to cause cancer.



© 2017 Louisiana-Pacific Corporation. All rights reserved. The UL mark is a registered trademark of Underwriters Laboratories, Inc. Sustainable Forestry Initiative and SFI are registered trademarks of Sustainable Forestry Initiative, Inc. Pyrotite is a registered trademark of Barrier Technology, Inc. All other trademarks are owned by Louisiana-Pacific Corporation.

Printed in USA.

LPF0109 5000 05/17